

- Notes:
1. Coordinates are in terms of New Zealand Transverse Mercator 2000 (NZTM).
 2. Where a boundary is shown along a river or road it follows the middle line of the physical river or legal road unless otherwise shown.
 3. All seaward boundaries follow Mean Low Water Springs but cross the mouths of all rivers, streams, inlets and estuaries unless otherwise shown.

Land District: West Coast

Grey District

TERRITORIAL AUTHORITY: Grey District
 Compiled by Coastwide Surveys Limited
 Scale: 1:310,000 @ A3 10 Dec 2018

LG-056-2018-W-1

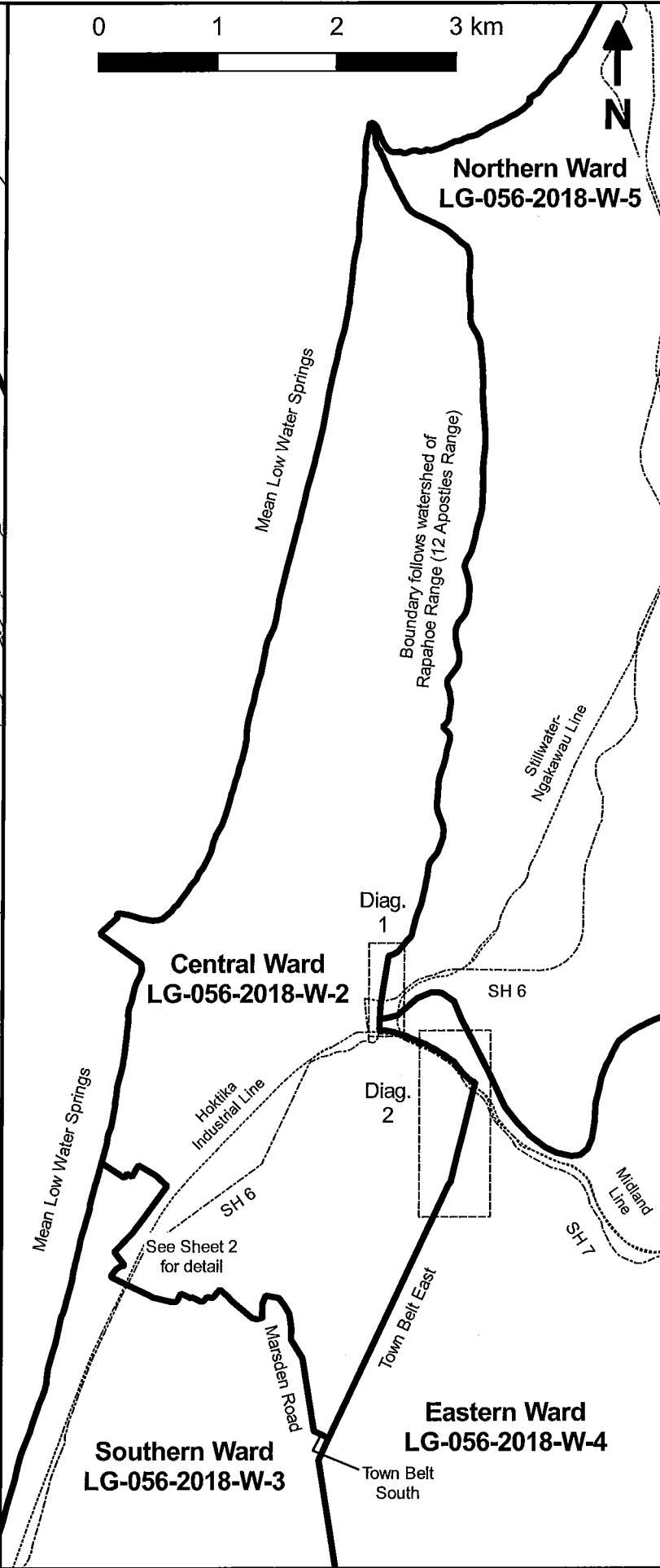
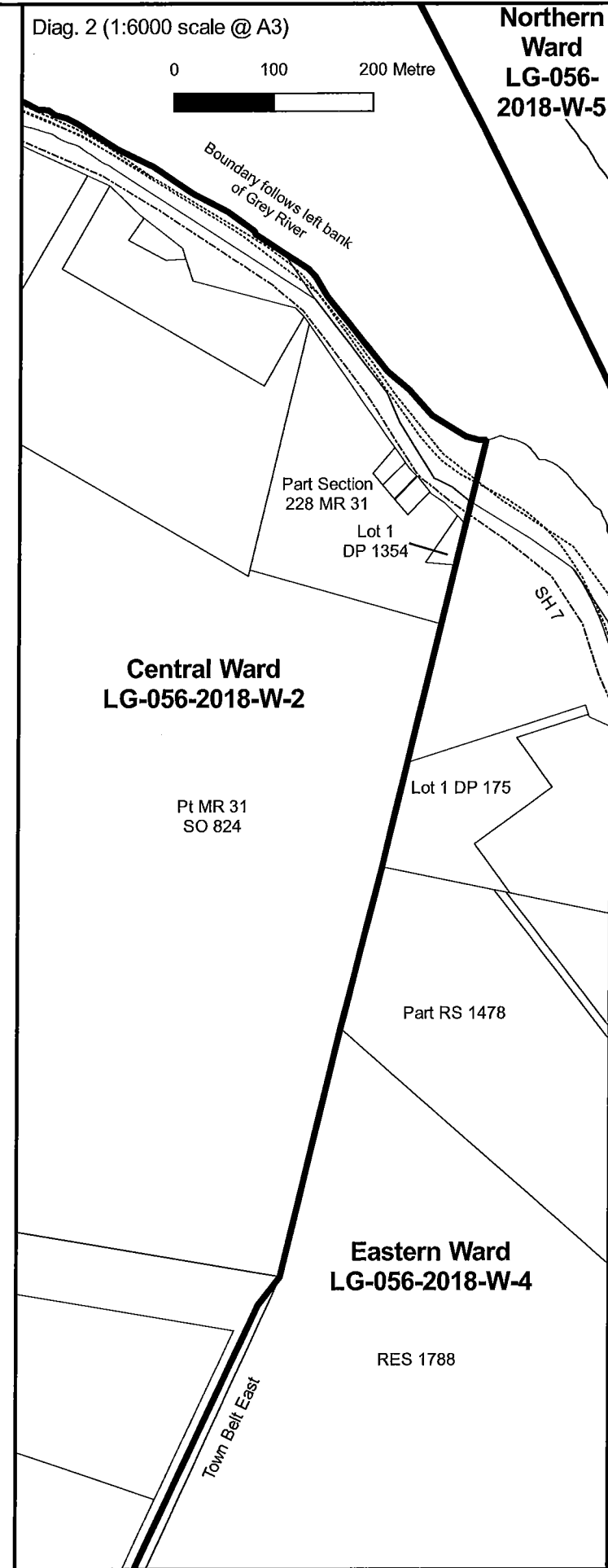
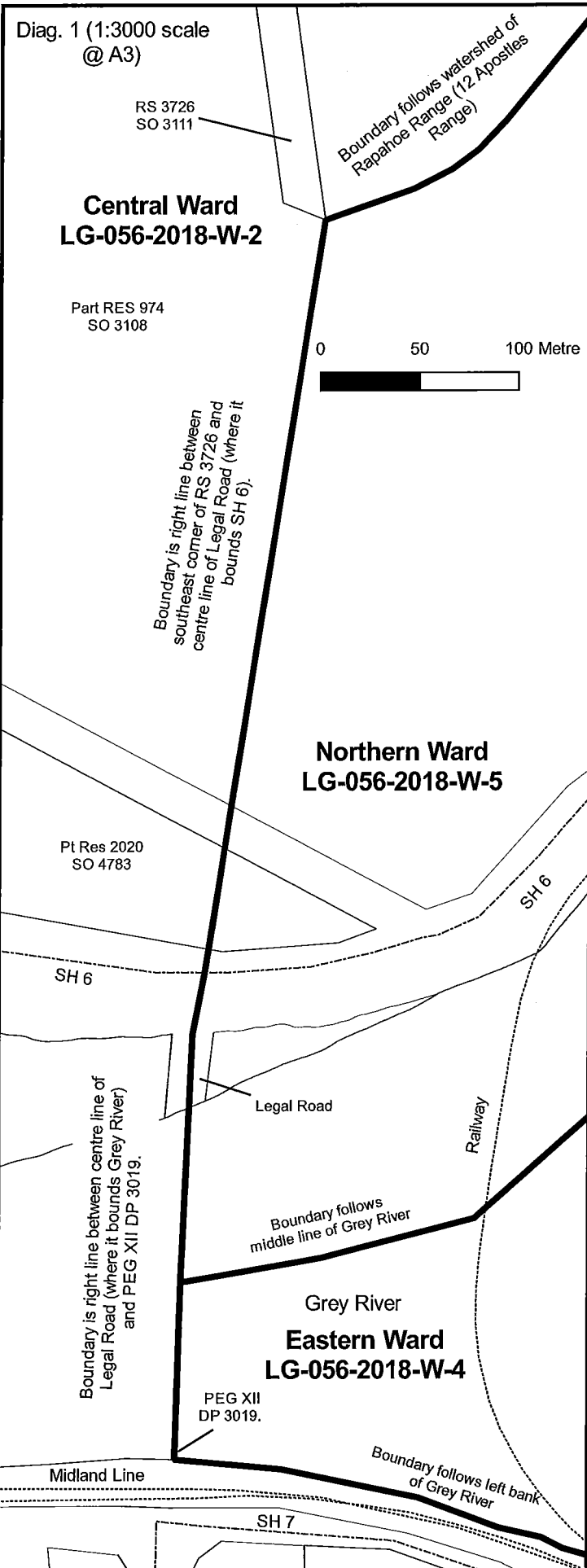

- Notes:
1. Coordinates are in terms of New Zealand Transverse Mercator 2000 (NZTM).
 2. Where a boundary is shown along a river or road it follows the middle line of the physical river or legal road unless otherwise shown.
 3. All seaward boundaries follow Mean Low Water Springs but cross the mouths of all rivers, streams, inlets and estuaries unless otherwise shown.
 4. All out-lying rocks and off-shore islands are part of the Central Ward

Land District: West Coast

**Grey District
Central Ward - Sheet 1 of 2**

TERRITORIAL AUTHORITY: Grey District
Compiled by Coastwide Surveys Limited

Scale: 1:50,000 @ A3 08 Jan 2019

**LG-056-2018-W-2
Sheet 1 of 2**

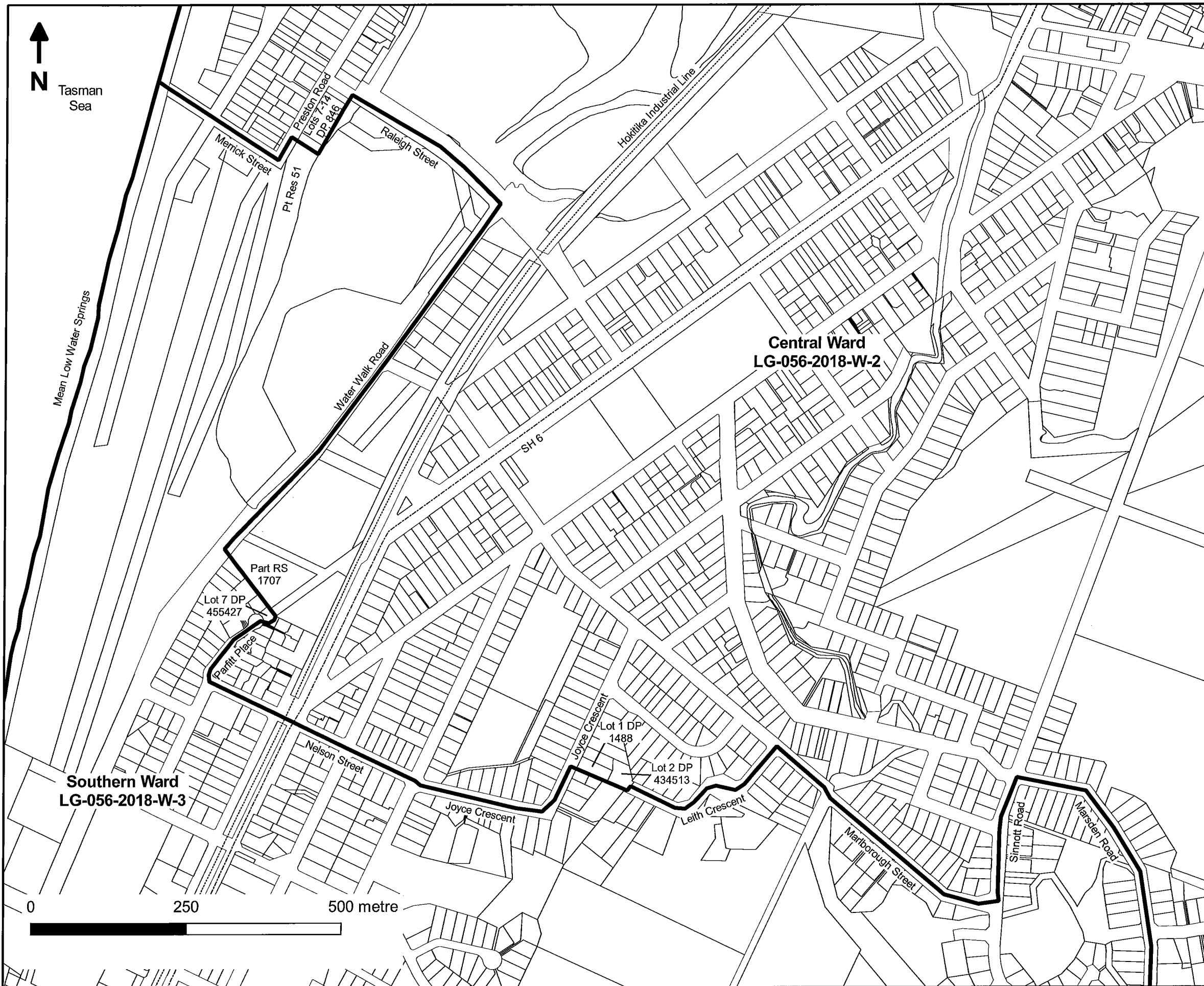

Notes:

1. Coordinates are in terms of New Zealand Transverse Mercator 2000 (NZTM).
2. Where a boundary is shown along a river or road it follows the middle line of the physical river or legal road unless otherwise shown.
3. All seaward boundaries follow Mean Low Water Springs but cross the mouths of all rivers, streams, inlets and estuaries unless otherwise shown.



Diag. 2 (1:3500 scale @A3)

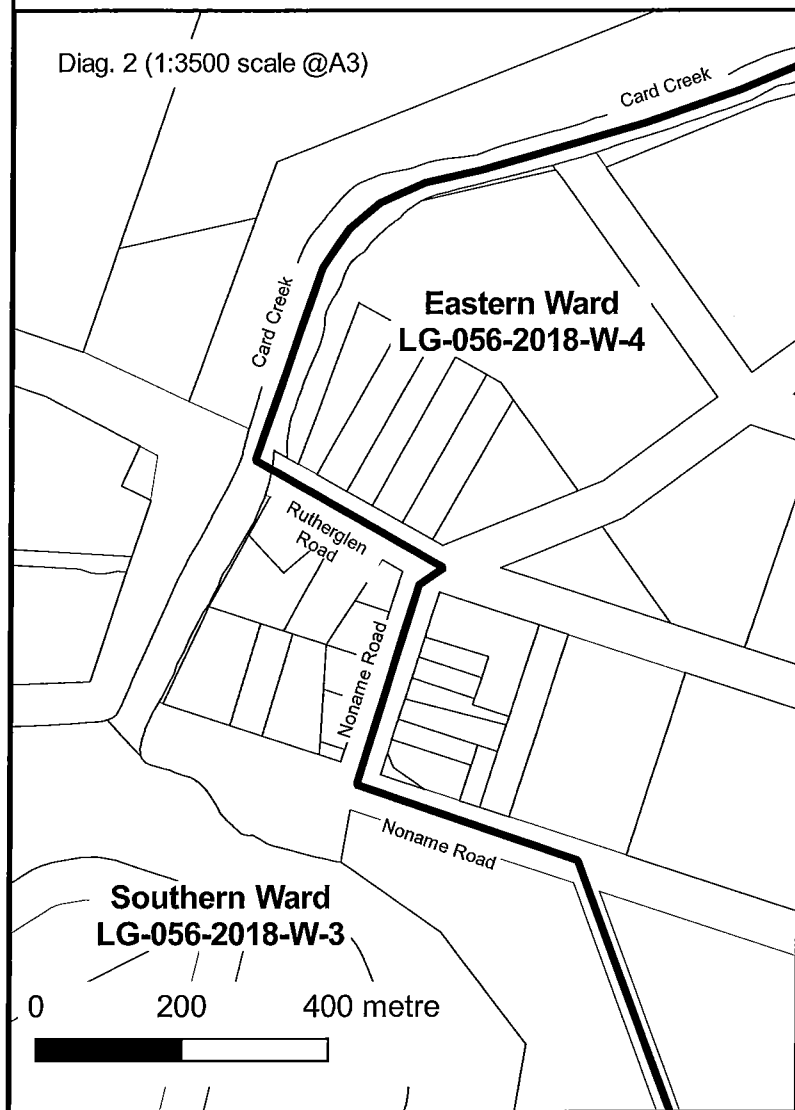

See LG-056-2018-W-2 Sheet 2 for boundary detail

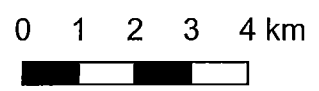

Eastern Ward
LG-056-2018-W-4

Tasman Sea

Mean Low Water Springs
SH 6

See Sheet 2 for boundary detail
AA Kakawau
Pt Sect 1
SO 12393
Lunamere
Creek

Diag. 2

Boundary is the middle line
of the Taramakau River

Noname Road

Noname Road

Southern Ward
LG-056-2018-W-3

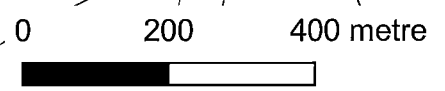

Westland District
Northern Ward
LG-057-2012-W-1

SH 73

Diag. 1

Kumara -
Inchbonnie Road

Kumara -
Inchbonnie Road

Eastern
Hobonui
River

Mt French Trig
No. 3

Boundary is right line
between middle
point of Lake
Ruby and Mt
French Trig No. 3

Southern Ward
LG-056-2018-W-3

Middle point
of Lake Ruby

Rubieslaw
Creek

Boundary is the middle line
of the Taramakau River

Boundary is the middle line
of the Taramakau River

Diag. 1 (1:10000 scale @A3)

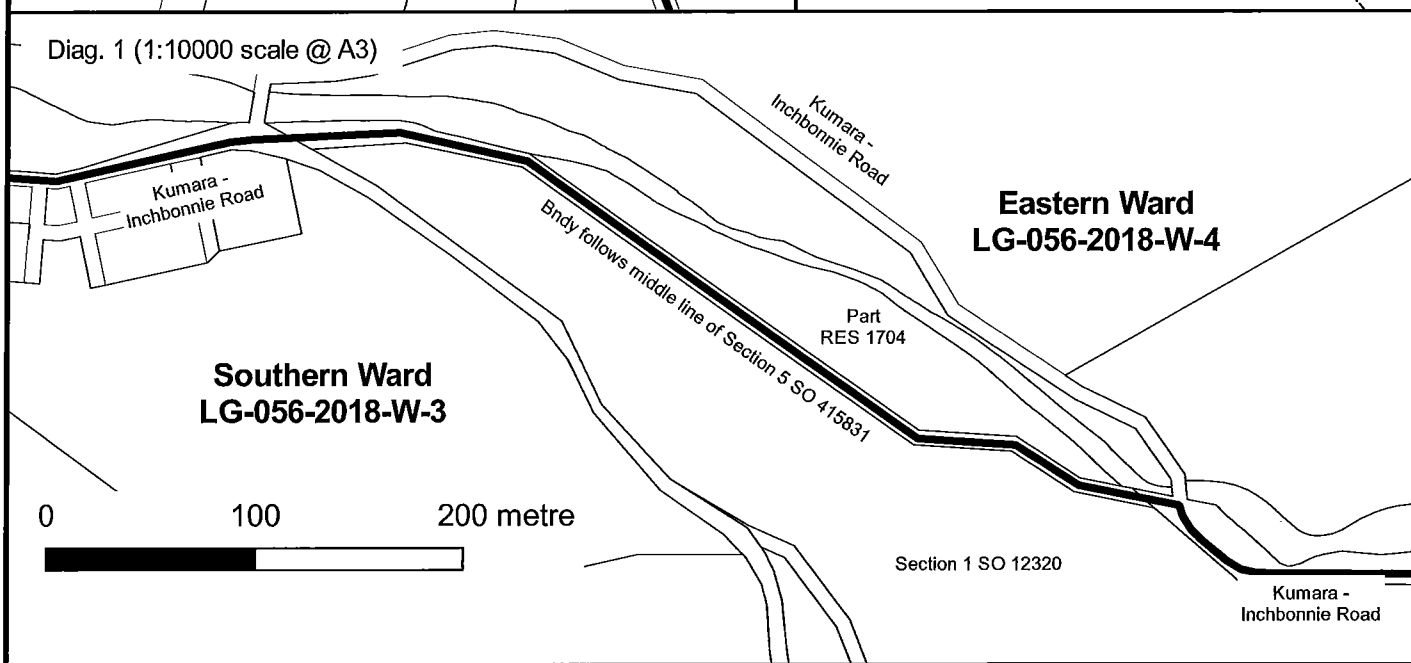

- Notes:
1. Coordinates are in terms of New Zealand Transverse Mercator 2000 (NZTM).
 2. Where a boundary is shown along a river or road it follows the middle line of the physical river or legal road unless otherwise shown.
 3. All seaward boundaries follow Mean Low Water Springs but cross the mouths of all rivers, streams, inlets and estuaries unless otherwise shown.
 4. All out-lying rocks and off-shore islands are part of the Southern Ward

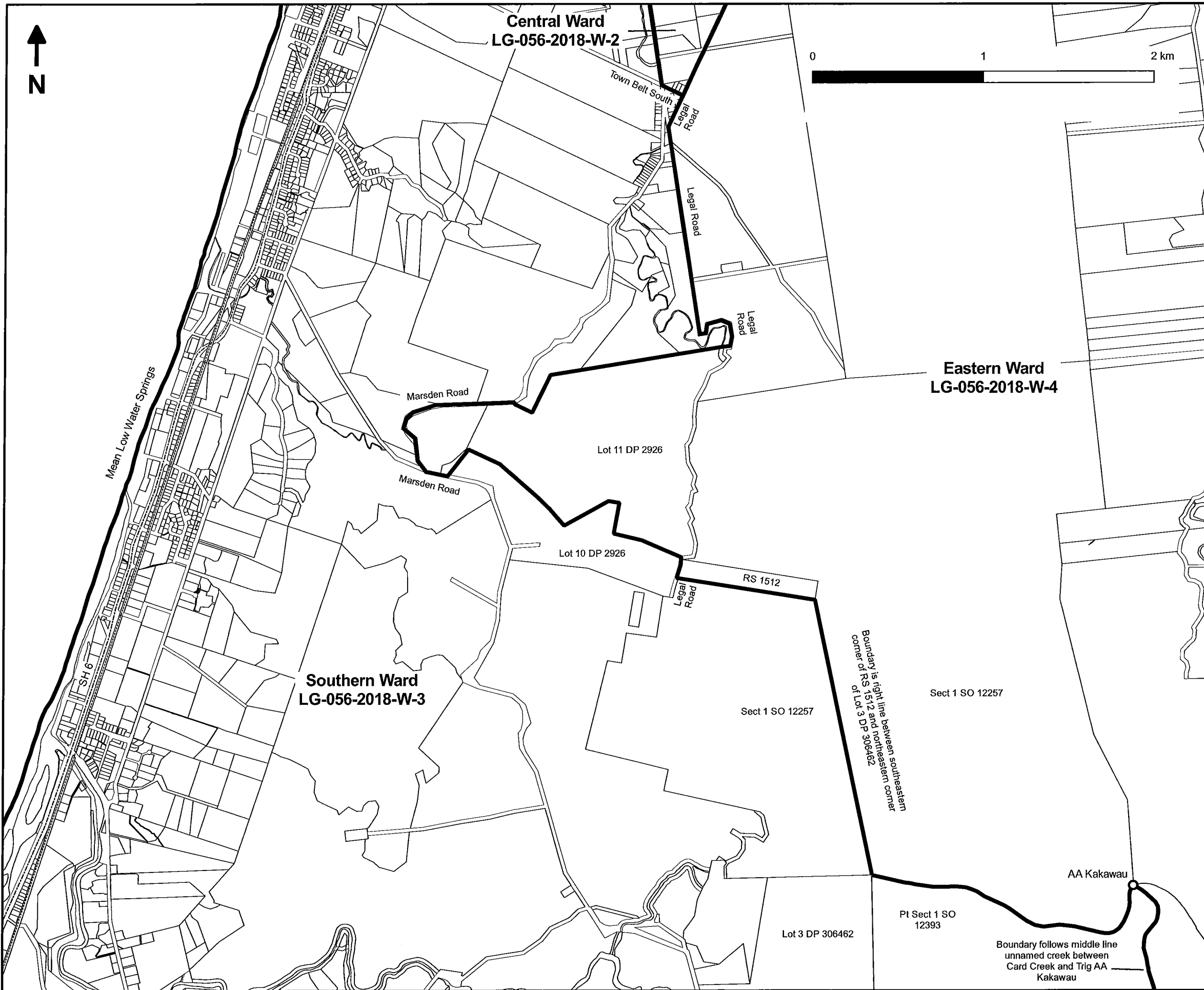

- Notes:
1. Coordinates are in terms of New Zealand Transverse Mercator 2000 (NZTM).
 2. Where a boundary is shown along a river or road it follows the middle line of the physical river or legal road unless otherwise shown.
 3. All seaward boundaries follow mean low water springs but cross the mouths of all rivers, streams, inlets and estuaries unless otherwise shown.

Land District: West Coast

Grey District
Southern Ward Sheet 2 of 2

TERRITORIAL AUTHORITY: Grey District
 Compiled by Coastwide Surveys Limited
 Scale: 1:22,000 @ A3 08 Jan 2019

LG-056-2018-W-3
Sheet 2 of 2

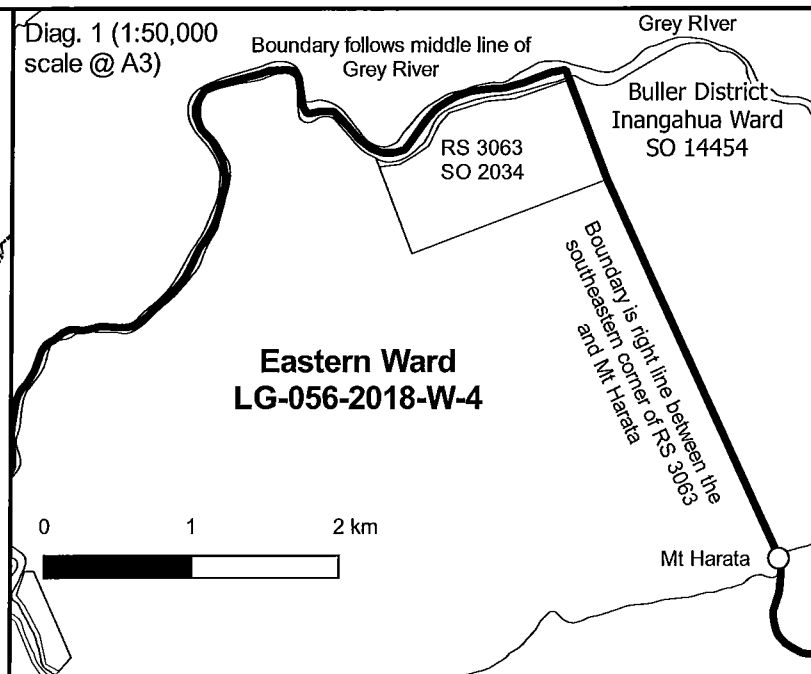
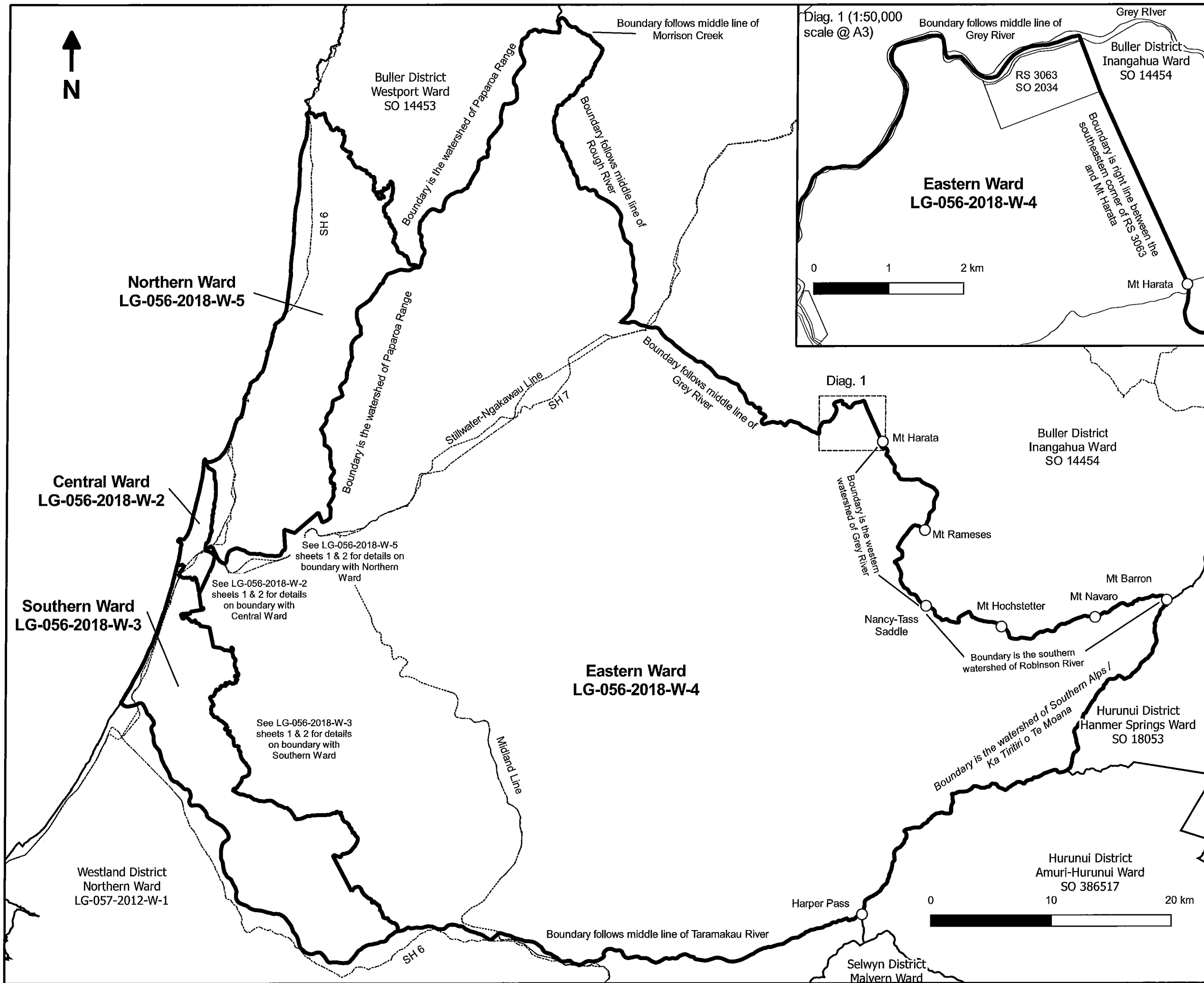

- Notes:
1. Coordinates are in terms of New Zealand Transverse Mercator 2000 (NZTM).
 2. Where a boundary is shown along a river or road it follows the middle line of the physical river or legal road unless otherwise shown.
 3. All seaward boundaries follow Mean Low Water Springs but cross the mouths of all rivers, streams, inlets and estuaries unless otherwise shown.

Land District: West Coast

Grey District Eastern Ward

TERRITORIAL AUTHORITY: Grey District
Compiled by Coastwide Surveys Limited
Scale: 1:310,000 @ A3 10 Dec 2018

LG-056-2018-W-4

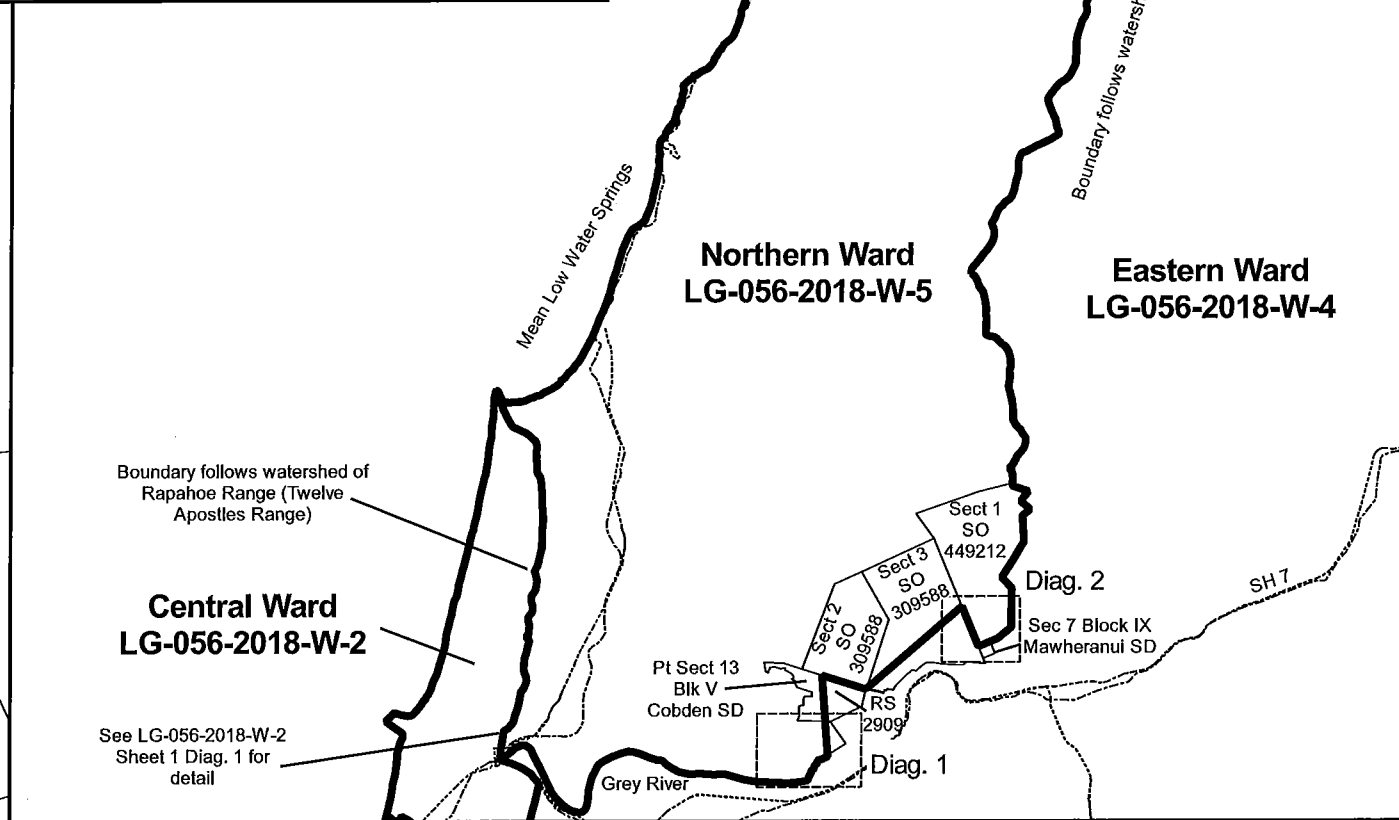
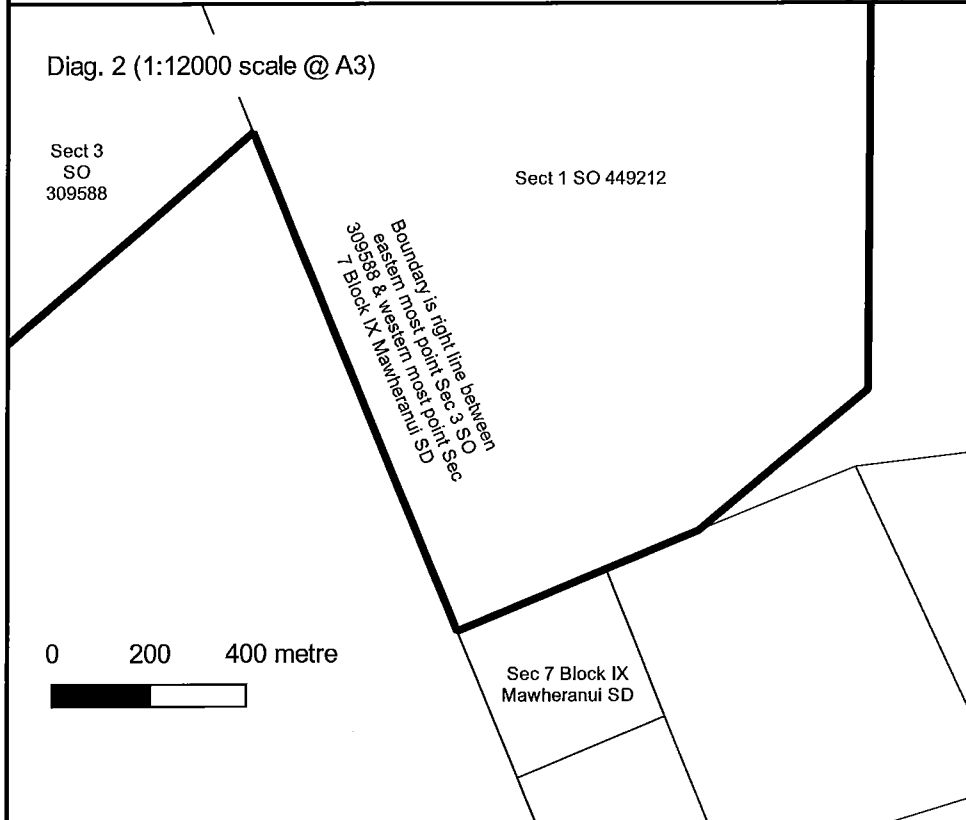
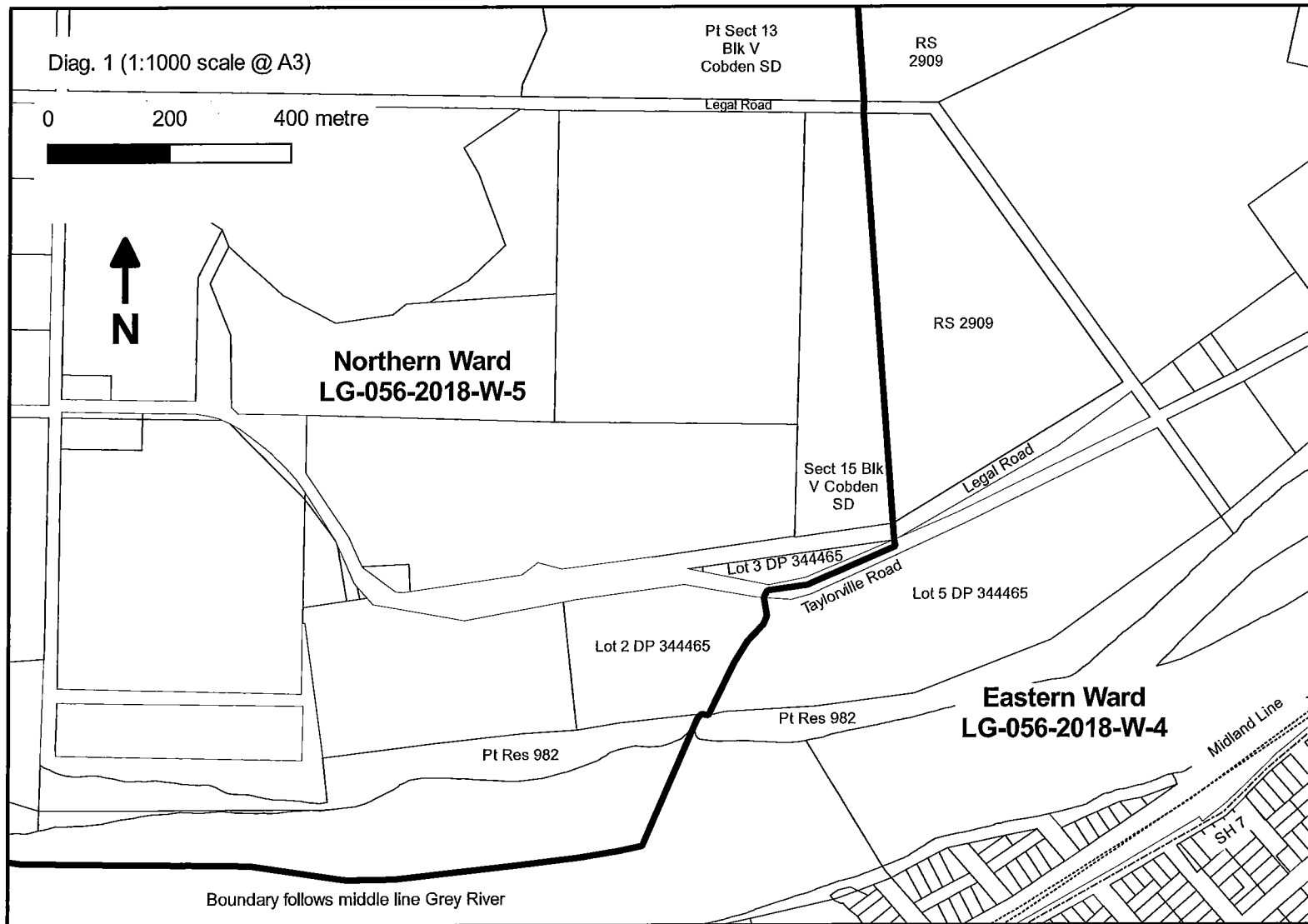

- Notes:
1. Coordinates are in terms of New Zealand Transverse Mercator 2000 (NZTM).
 2. Where a boundary is shown along a river or road it follows the middle line of the physical river or legal road unless otherwise shown.
 3. All seaward boundaries follow Mean Low Water Springs but cross the mouths of all rivers, streams, inlets and estuaries unless otherwise shown.
 4. All out-lying rocks and off-shore islands are part of the Northern Ward

Land District: West Coast

Grey District Northern Ward

TERRITORIAL AUTHORITY: Grey District
Compiled by Coastwide Surveys Limited

Scale: 1:150,000 @ A3 08 Jan 2019

LG-056-2018-W-5

I certify that the boundaries shown on the plans numbered LG-056-2018-W-1, LG-056-2018-W-2, LG-056-2018-W-3, LG-056-2018-W-4 and LG-056-2018-W-5 are the same as boundaries determined by a resolution of the GREY DISTRICT COUNCIL on 11 June 2018 and publicly notified under Section 19Y(1) of the Local Electoral Act 2001.

The plans numbered LG-056-2018-W-1, LG-056-2018-W-2, LG-056-2018-W-3, LG-056-2018-W-4 & LG-056-2018-W-5

Replace the existing plan numbered LG-056-2013-W-1

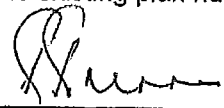
Signed:  Date 15.1.19

Paul Pretorius
Chief Executive
GREY DISTRICT COUNCIL

I certify that the plans numbered LG-056-2018-W-1, LG-056-2018-W-2, LG-056-2018-W-3, LG-056-2018-W-4 & LG-056-2018-W-5 renders the boundaries capable of identification for the purposes of section 19Y(3)(b) of the Local Electoral Act 2001.



Gary Regaldo

18 / 1 / 2019

Technical Advisor Survey, Land Information New Zealand

Pursuant to a delegation from the Surveyor-General under section 8 of the Cadastral Survey Act 2002