

GREY DISTRICT COUNCIL

2024 REPRESENTATION REVIEW PROPOSAL

Initial Proposal for representation arrangements for the 2025 local elections

On 13 May 2024 the Grey District Council reviewed its representation arrangements, and resolved that the following proposal apply for the Council for the elections to be held on 11 October 2025 (Attachment 1).

Issues relating to fair and effective representation

The Local Electoral Act 2001 requires Councils to implement “fair and effective representation for individuals and communities” In its discussions, it was concluded that “fair representation” focuses on individuals, i.e. one-person-one-vote-one-value, whilst “effective representation” focuses more on representation of communities.

Council confirmed the following as distinct “**communities of interest**”.

- The **Northern Ward** including primarily Runanga, Rapahoe and Barrytown as historically coal mining settlements.
- The **Eastern Ward** including settlements like Blackball, Stillwater, Dobson, Nelson Creek, Ngahere and Moana as traditionally farming and farming related areas. Moana is perhaps not quite aligned but with a mostly weekend population and its distance away from other more residential settlements, a change of Ward boundaries has not been deemed as productive at this point.
- The **Southern Ward** including Karoro, South Beach, Gladstone, Camerons, and the new residential areas in the Paroa area, as the more modern, residential development area with a predominantly young, white-collar population.
- The **Central Ward** being Greymouth, Blaketown and Cobden as the original Greymouth area housing an established and slightly older population with a long-established social cohesion.

Does the ward system provide for “**fair and effective representation**”? Council has been using the ward system for all the Representation Review cycles up to now and deem it effective in that:

- Ward sizes are small enough to provide for easy and productive contact between Councillor and resident and between resident and full Council.
- It is a well proven system.
- It is simple and easily understandable to the public.
- Communities of interest is well served by current ward boundaries.

The current ward system and existing ward boundaries as an option

In accordance with section 19V(2), Local Electoral Act 2001 the population that each member represents must be within the range of 1783 +/- 10%, unless particular community of interest considerations justify otherwise.

Statistics NZ population estimates: 2023

Ward	Population	Councillor / Population	10% Range	Outside/Inside Range
Northern	1,690	(1) 1690/1,783	-93	-5.19% OK
Central	5,110	(3) 1703/1783	-79	-4.44% OK
Southern	3,670	(2) 1,835/1783	53	2.95% OK
Eastern	3,790	(2) 1,895/1783	113	6.31% OK
Totals	14,260	(8) 1,783		

All wards are within the +/- variation

Maps showing ward boundaries are attached hereto (Attachment 2)

A mixture of Ward and “at large” or an only “at large” system of representation

Council does not believe that:

- Any change in a simple ward representation will have benefits over status quo, neither on the basis of fairness and efficiency nor in relation to providing for communities of interest.
- A reduction in the number of wards will certainly impact on effective representation whilst an increase in wards will not improve current efficiency and fairness.

A purely “at large” system is numerically easy but introduces difficulties which, in the opinion of Council introduces important challenges to representation.

Representation of Māori

Council recognises the political and cultural importance of the “Māori seat” debate. Based on the formula provided in Cl.2 of Schedule 1A of the Local Elections Act 2002 Māori will qualify for one seat, elected “at large”. New legislation is currently being enacted by the Crown restoring a public Poll as basis for any decision to provide for a Māori seat on Council.

Council is being led by the direction provided to it by the local Iwi on this question. Te Rūnanga o Ngāti Waewae advise that its attendance on Council Committees is deemed most valuable and, for that reason it does not support a Māori seat on Council. On that basis, Council is **not** proposing to create a Māori seat.

Creation of Community Boards

Council deems the Ward system in place as providing most efficiently for specific communities of interest within the District. Historically, the Northern Ward as a separate local authority prior to the 1989 Reorganisation had a Community Board, but this has since been abandoned some years ago.

Further Information

Copies of the Council’s resolution and maps setting out the areas of the proposed wards, communities and subdivisions may be viewed and obtained from

Grey District Council Offices, Corner Puketahi Street and Tainui Street, Greymouth.

Any queries regarding the Council’s decision should be directed to Catriona Bayliss, 03 744 7149 or Catriona.bayliss@greydc.govt.nz.

Relevant information is also available on the Council’s website greydc.govt.nz.

Submissions are invited

Persons with an interest in the proposed representation arrangements are invited to make written submissions on the Council’s representation proposal.

Submissions are to be forwarded to:

Catriona Bayliss

- Email: **Catriona.bayliss@greydc.govt.nz**
- Postal Address: Grey District Council, PO Box 482, Greymouth 7840
- Physical Address: Grey District Council, Cnr Puketahi and Tainui Streets, Greymouth

Submissions must be received by Council no later than 26 June 2024.

Extract from Ordinary Meeting of the Grey District Council held on 13 May 2024

Full minutes can be viewed on the Grey District Council website – greydc.govt.nz

5.6 REPRESENTATION REVIEW: TRIENNIAL REVIEW

RESOLUTION OCM 24/05/001

Moved: Cr Kate Kennedy

Seconded: Cr John Canning

That Council confirms the process followed during previous Representation Reviews and:

1. Takes note of statutory and other considerations involved.
2. Confirms that each community enjoys effective representation and that there is no need for Community Boards.
3. Based on the views of local Iwi on the matter, Council determines that a Māori Ward or wards not be created. In this respect, it is noted that the Kaiwhakahaere of Te Rūnanga O Ngāti Waewae enjoys a seat and full voting rights on Council's Committees and the right to attend and participate (but not vote) at Council meetings and that the Rūnanga does not want a seat on Council.
4. Confirms four Wards and retention of current boundaries, noting that 2024 Census data confirms voter dispersion and representation conforming to the +/- 10% variation requirement.
5. For the purposes of the above, confirms that:
 - The above provides fair and effective representation for the communities of interest, is simple, easily understandable, and implementable and that it conforms with statutory requirements.
6. That Council approves the Draft Representation Proposal attached hereto as Annexure A and notifies it for public input per the proposal and the summary proposal.
7. That Council notes the process requirements for the process as a whole as outlined in Annexure B.

Carried Unanimously

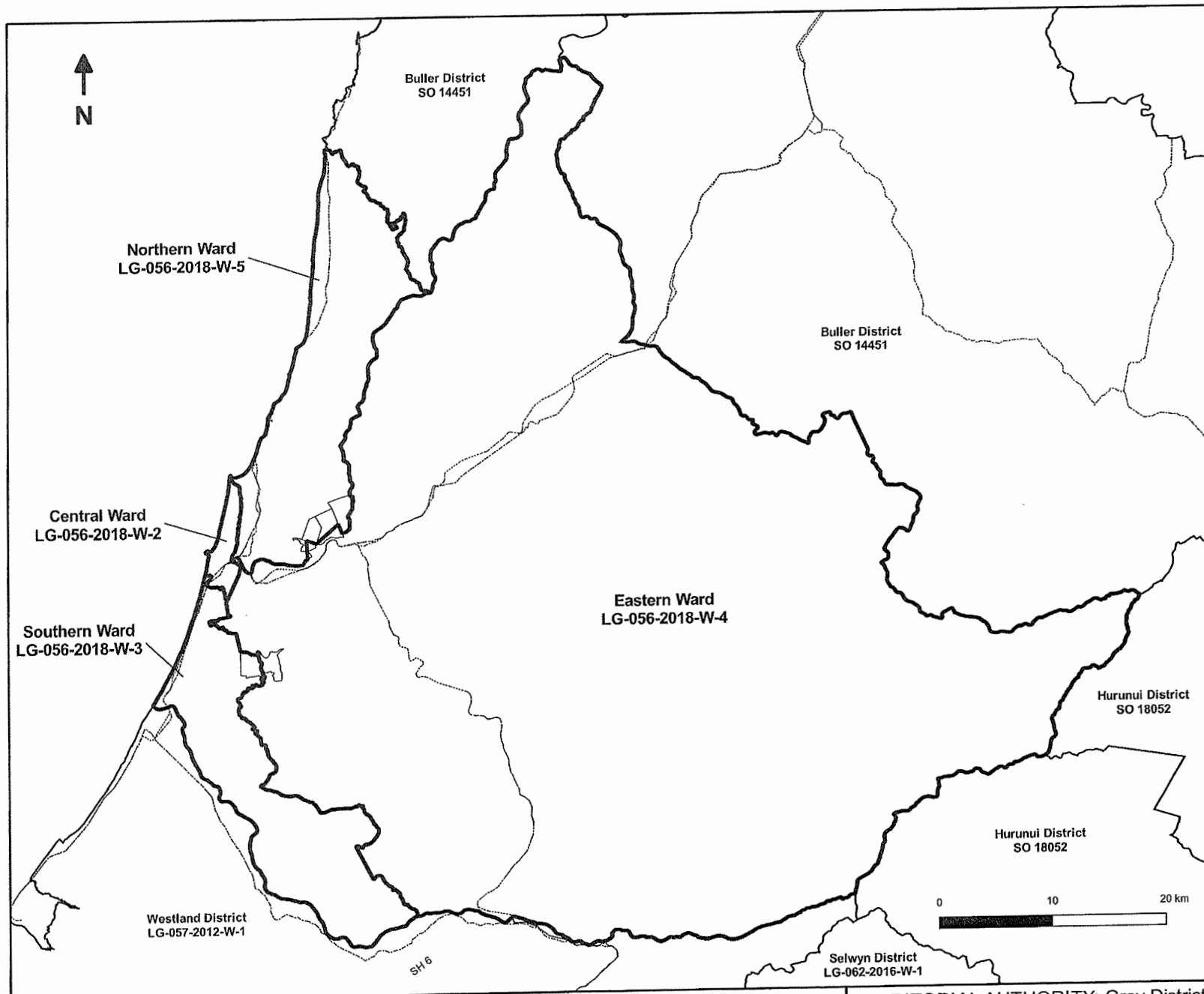

Notes:

1. Coordinates are in terms of New Zealand Transverse Mercator 2000 (NZTM).
2. Where a boundary is shown along a river or road it follows the middle line of the physical river or legal road unless otherwise shown.
3. All seaward boundaries follow Mean Low Water Springs but cross the mouths of all rivers, streams, inlets and estuaries unless otherwise shown.

Land District: West Coast

Grey District

TERRITORIAL AUTHORITY: Grey District
Compiled by Coastwide Surveys Limited

Scale: 1:310,000 @ A3

10 Dec 2018

LG-056-2018-W-1

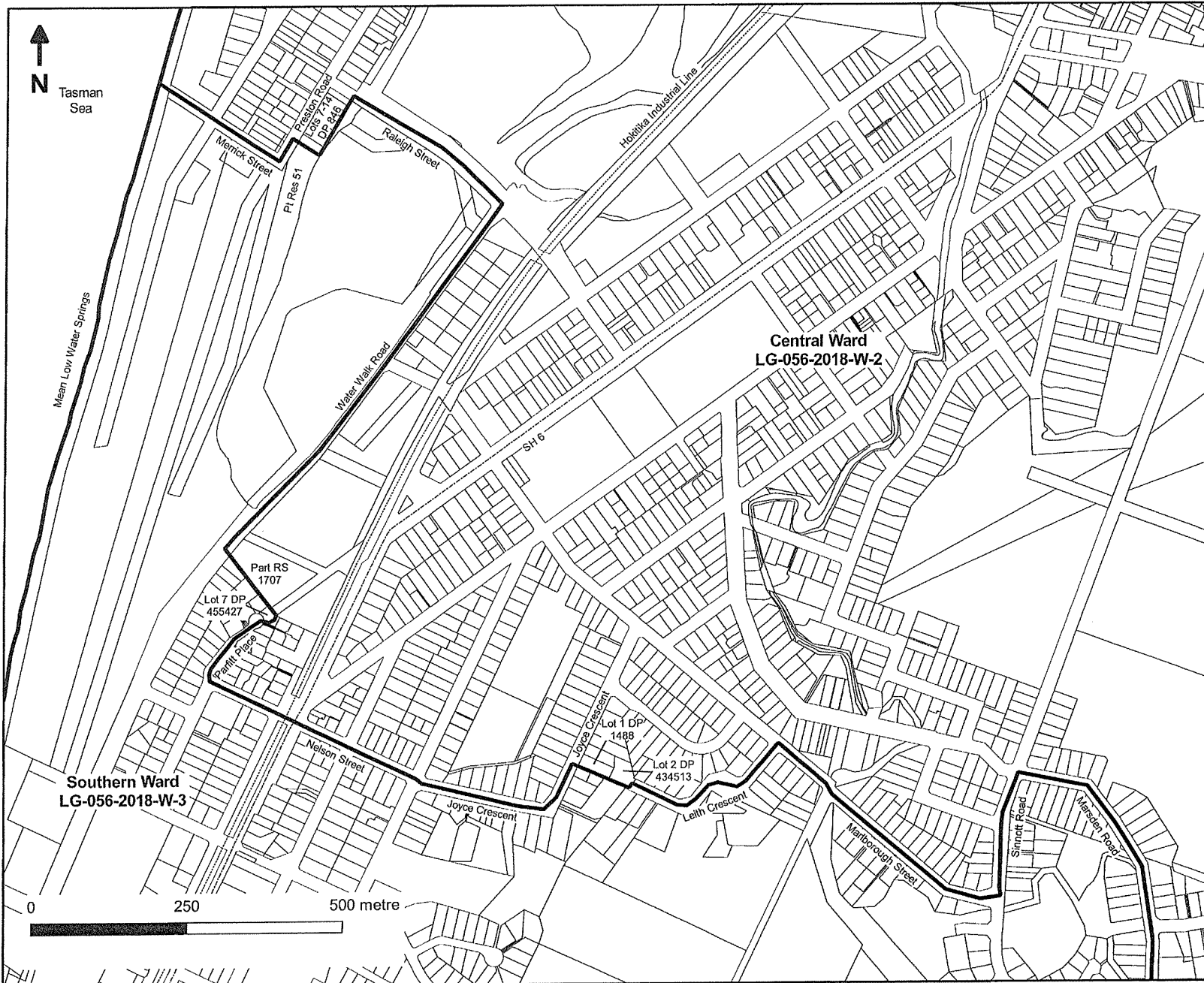

Notes:

1. Coordinates are in terms of New Zealand Transverse Mercator 2000 (NZTM).
2. Where a boundary is shown along a river or road it follows the middle line of the physical river or legal road unless otherwise shown.
3. All seaward boundaries follow Mean Low Water Springs but cross the mouths of all rivers, streams, inlets and estuaries unless otherwise shown.

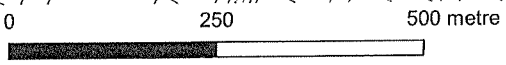

Land District: West Coast

**Grey District
Central Ward - Sheet 2 of 2**

TERRITORIAL AUTHORITY: Grey District
Compiled by Coastwide Surveys Limited

Scale: 1:6,000 @ A3

08 Jan 2019

**LG-056-2018-W-2
Sheet 2 of 2**

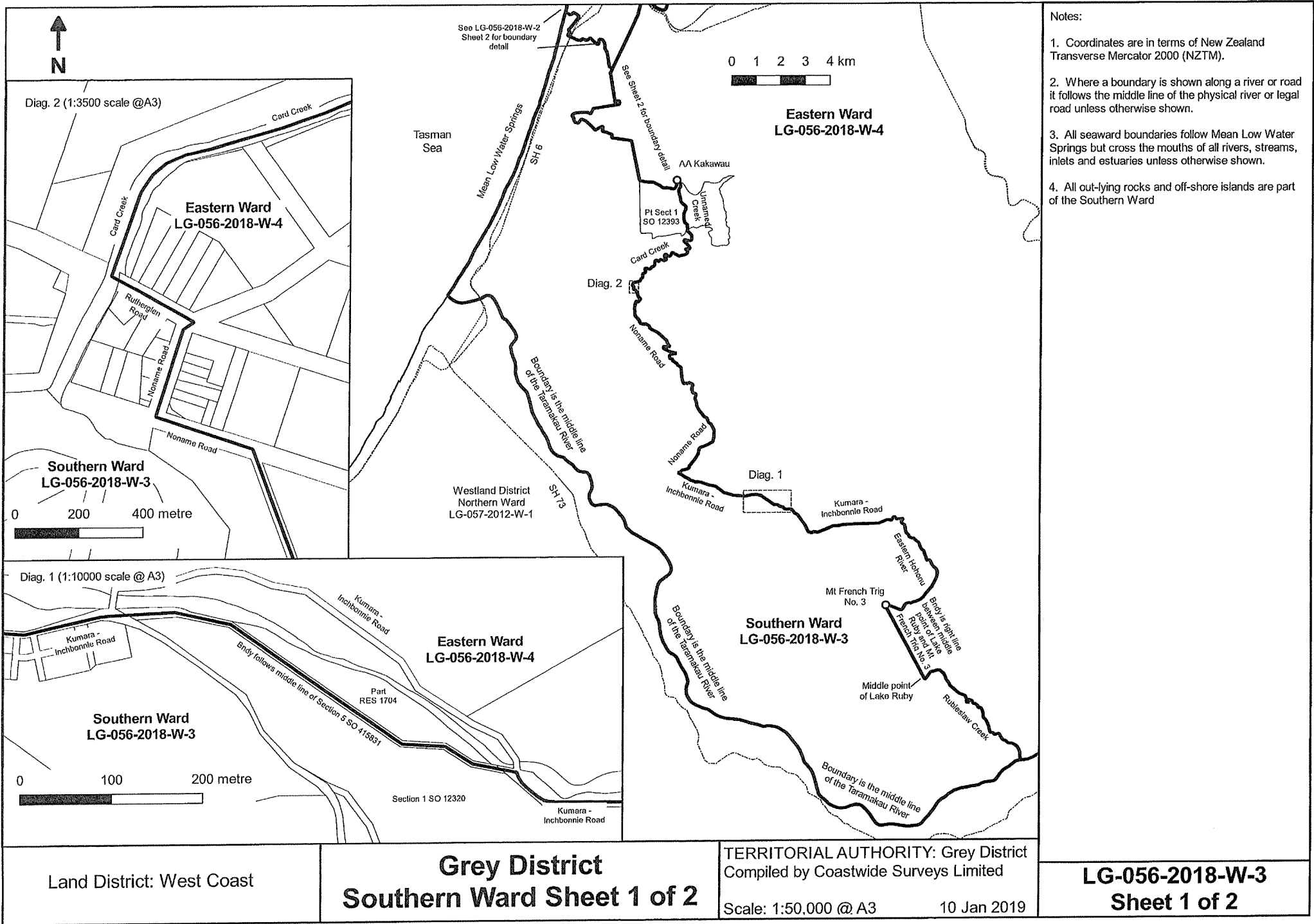

Land District: West Coast

Grey District
Southern Ward Sheet 1 of 2

TERRITORIAL AUTHORITY: Grey District
 Compiled by Coastwide Surveys Limited

Scale: 1:50,000 @ A3 10 Jan 2019

LG-056-2018-W-3
Sheet 1 of 2

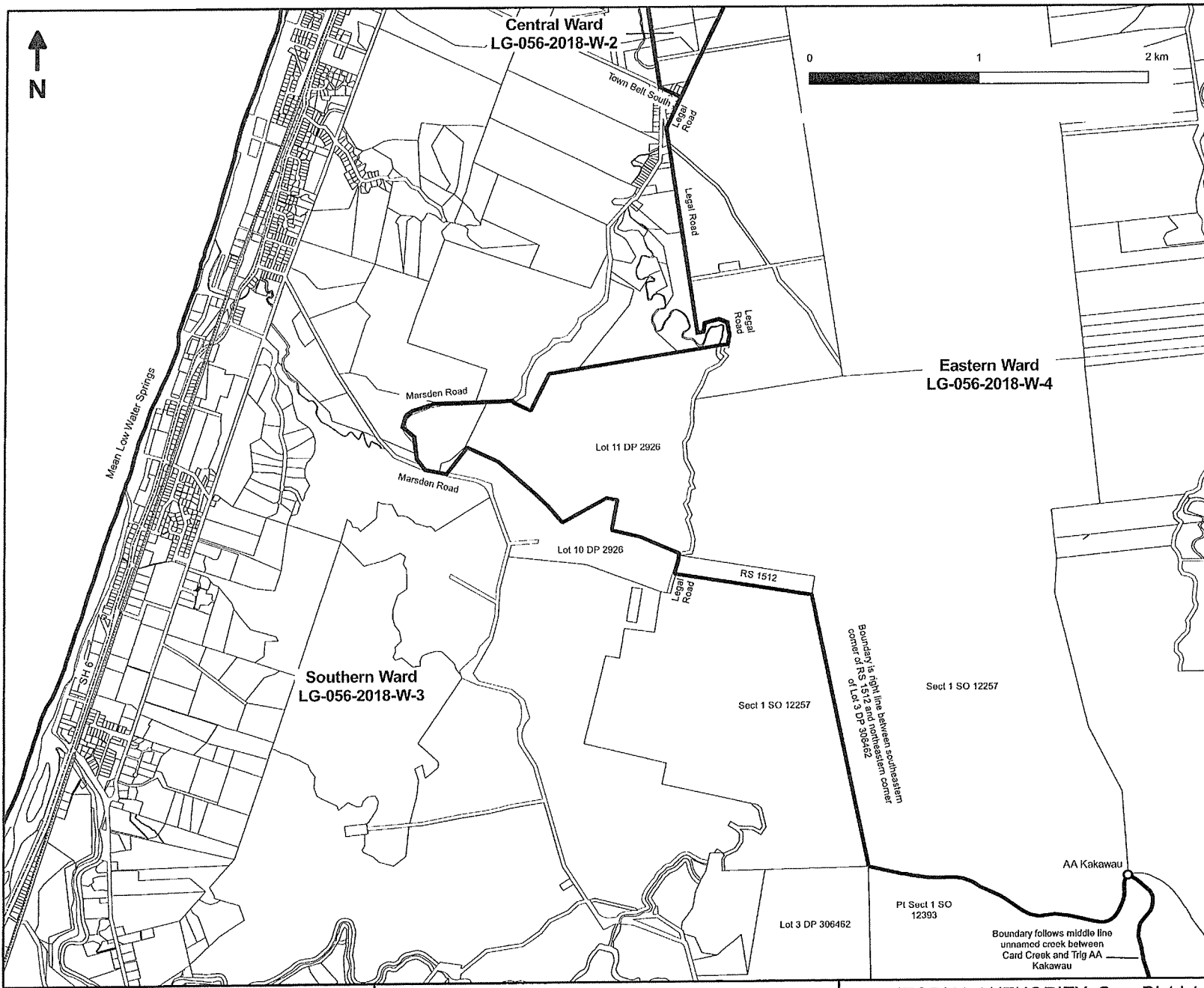

- Notes:
1. Coordinates are in terms of New Zealand Transverse Mercator 2000 (NZTM).
 2. Where a boundary is shown along a river or road it follows the middle line of the physical river or legal road unless otherwise shown.
 3. All seaward boundaries follow mean low water springs but cross the mouths of all rivers, streams, inlets and estuaries unless otherwise shown.

Land District: West Coast

Grey District
Southern Ward Sheet 2 of 2

TERRITORIAL AUTHORITY: Grey District
 Compiled by Coastwide Surveys Limited
 Scale: 1:22,000 @ A3 08 Jan 2019

LG-056-2018-W-3
Sheet 2 of 2

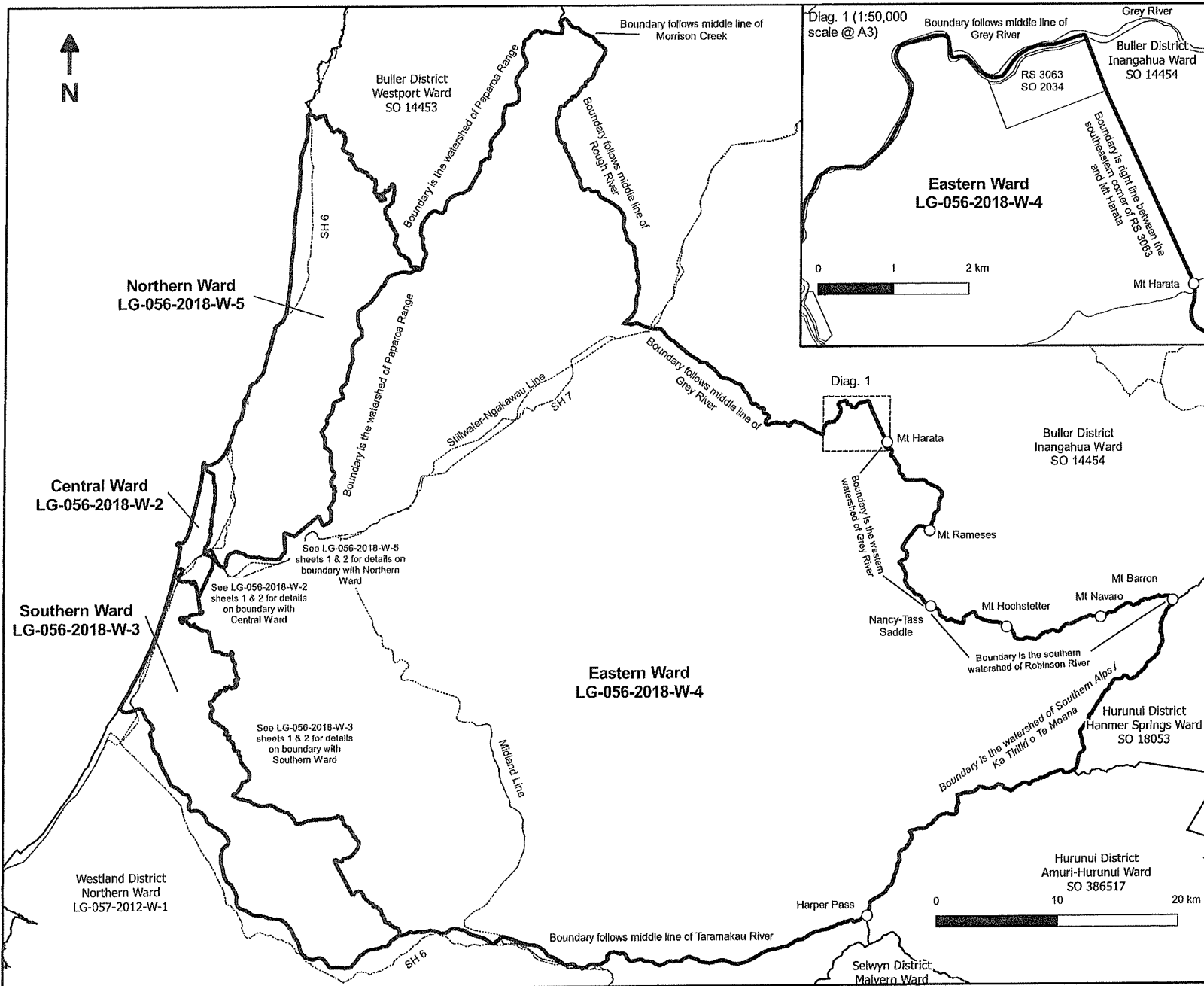

Notes:

- Coordinates are in terms of New Zealand Transverse Mercator 2000 (NZTM).
- Where a boundary is shown along a river or road it follows the middle line of the physical river or legal road unless otherwise shown.
- All seaward boundaries follow Mean Low Water Springs but cross the mouths of all rivers, streams, inlets and estuaries unless otherwise shown.

Land District: West Coast

**Grey District
Eastern Ward**

TERRITORIAL AUTHORITY: Grey District
Compiled by Coastwide Surveys Limited
Scale: 1:310,000 @ A3 10 Dec 2018

LG-056-2018-W-4

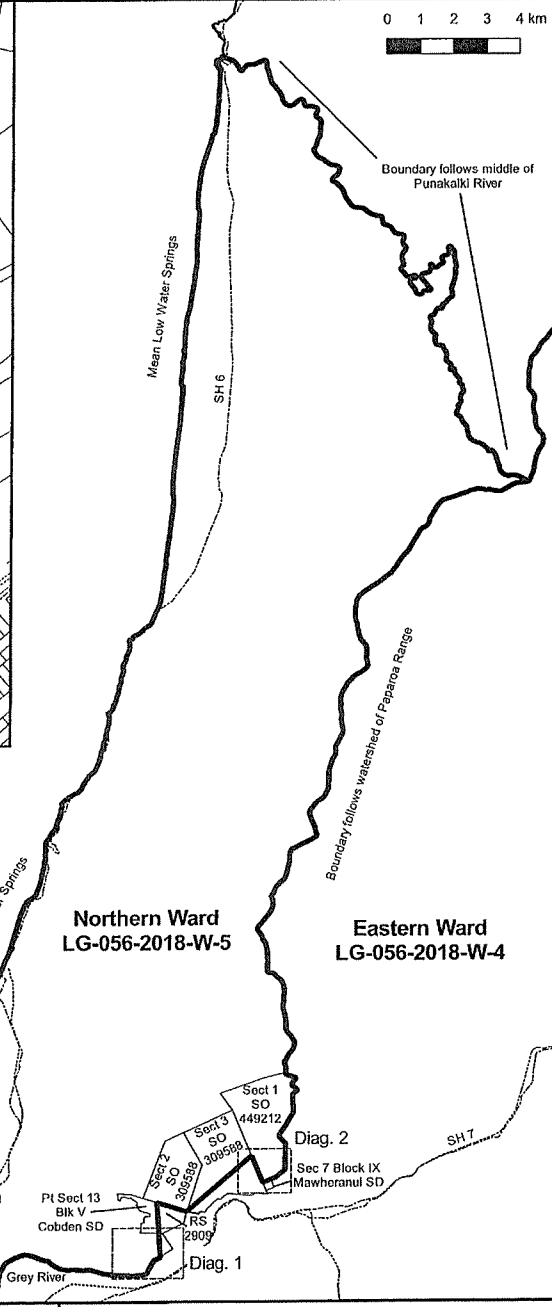
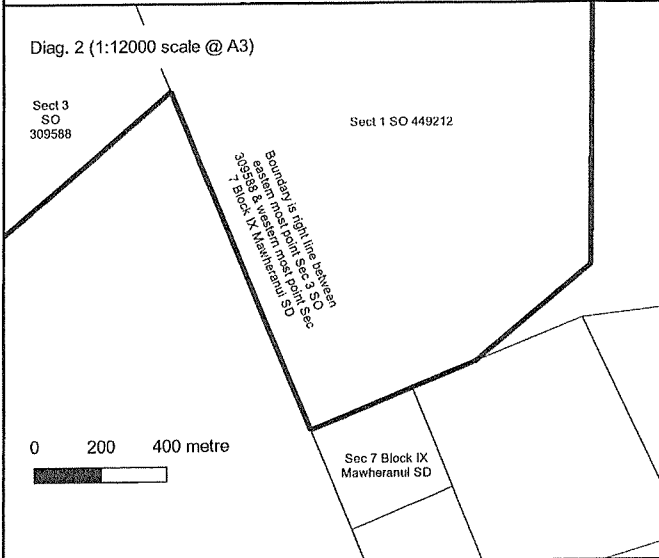
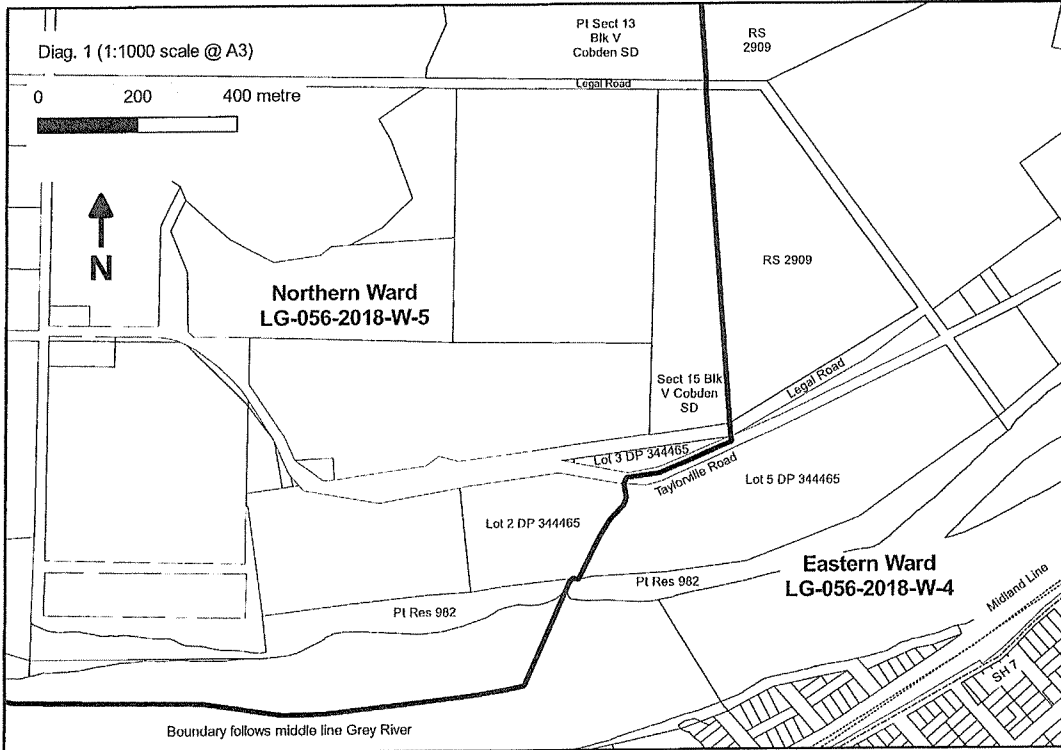

- Notes:
1. Coordinates are in terms of New Zealand Transverse Mercator 2000 (NZTM).
 2. Where a boundary is shown along a river or road it follows the middle line of the physical river or legal road unless otherwise shown.
 3. All seaward boundaries follow Mean Low Water Springs but cross the mouths of all rivers, streams, inlets and estuaries unless otherwise shown.
 4. All out-lying rocks and off-shore islands are part of the Northern Ward

Land District: West Coast

**Grey District
Northern Ward**

TERRITORIAL AUTHORITY: Grey District
Compiled by Coastwise Surveys Limited

Scale: 1:150.000 @ A3 08 Jan 2019

LG-056-2018-W-5

I certify that the boundaries shown on the plans numbered LG-056-2018-W-1, LG-056-2018-W-2, LG-056-2018-W-3, LG-056-2018-W-4 and LG-056-2018-W-5 are the same as boundaries determined by a resolution of the GREY DISTRICT COUNCIL on 11 June 2018 and publicly notified under Section 19Y(1) of the Local Electoral Act 2001.

The plans numbered LG-056-2018-W-1, LG-056-2018-W-2, LG-056-2018-W-3, LG-056-2018-W-4 & LG-056-2018-W-5

Replace the existing plan numbered LG-056-2013-W-1

Signed: _____

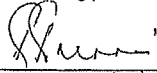

Date

15.1.19

Paul Pretorius
Chief Executive
GREY DISTRICT COUNCIL

I certify that the plans numbered LG-056-2018-W-1, LG-056-2018-W-2, LG-056-2018-W-3, LG-056-2018-W-4 & LG-056-2018-W-5 renders the boundaries capable of identification for the purposes of section 19Y(3)(b) of the Local Electoral Act 2001.



Gary Regaldo

18 / 1 / 2019

Technical Advisor Survey, Land Information New Zealand

Pursuant to a delegation from the Surveyor-General under section 8 of the Cadastral Survey Act 2002